

HSIIDC I.E. BAHADURGARH

REVISED LAYOUT PLAN OF SECTOR 16&17

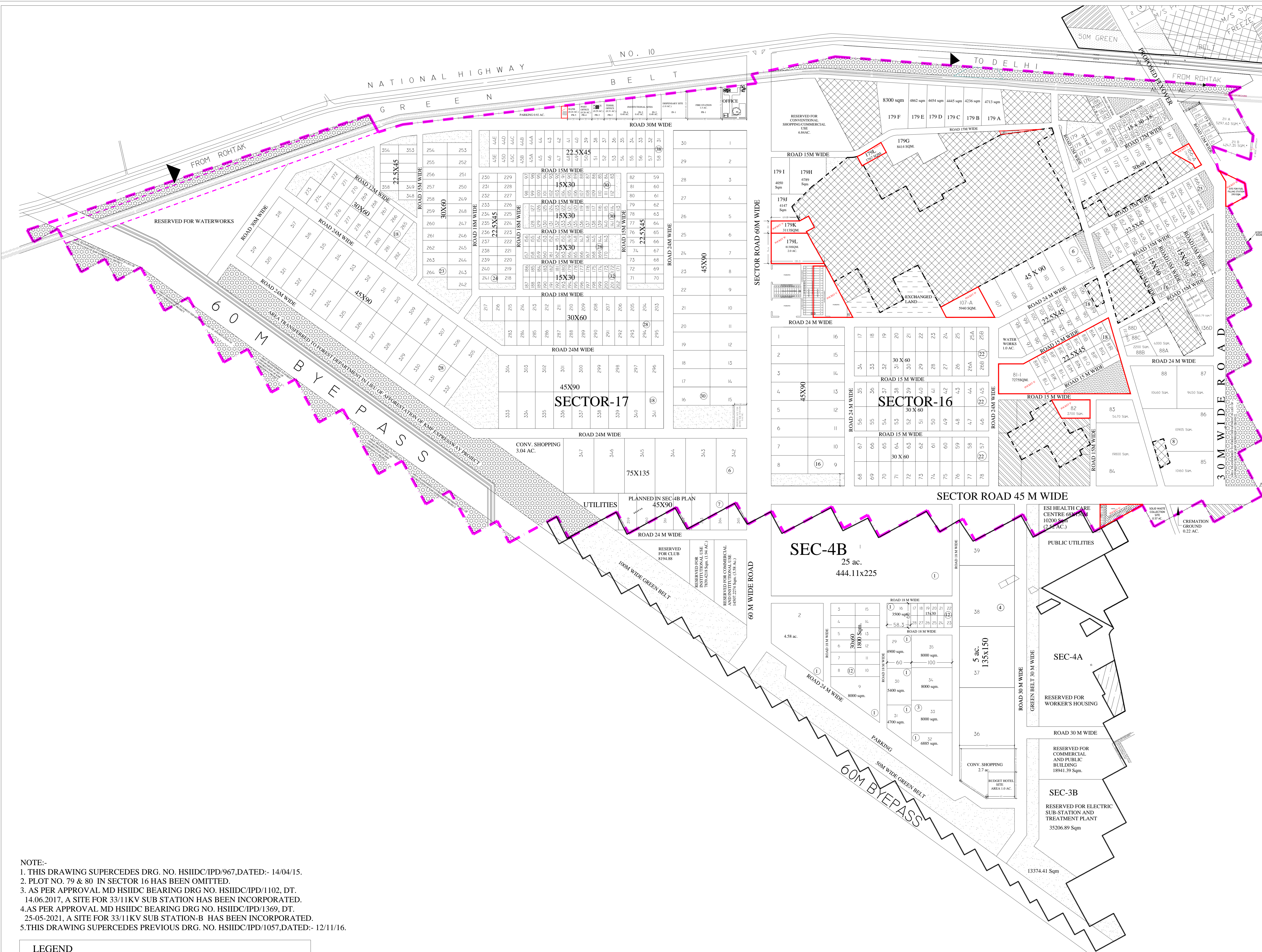

S.NO	CATEGORY	AREA (in acres)
SCHEDULE OF AREA		
	TOTAL NOTIFIED AREA	616.18
	AREA RELEASED AFTER U/S 4	61.00
	AREA RELEASED U/S 48	14.99
	TOTAL ACQUIRED AREA	540.19

S.NO	CATEGORY	AREA (in acres)
TOTAL AREA UNDER SECTOR-16		224.27
1	AREA TO BE PLANNED LATER	7.33
2	NET PLANNED AREA	216.94
3	AREA UNDER INDUSTRIAL PLOTS	132.31
4	AREA UNDER CONV. SHOPS/COMMERCIAL USE & PARKING	13.05
5	AREA UNDER ESI HEALTH CARE CENTRE	1.62
6	AREA UNDER WATER WORKS	1.00
7	AREA UNDER SOLID WASTE COLLECTION SITE	0.57
8	AREA RESERVED FOR FUEL FILLING STATION	0.55
9	AREA UNDER 33KV/11 SUB STATION-B	0.44
10	AREA UNDER CREMATION GROUND	0.22
11	AREA UNDER AUTO STAND	0.08
12	AREA UNDER GREEN BELT, ROADS, OPEN SPACES ETC.	67.10

S.NO	CATEGORY	AREA (in acres)
TOTAL AREA UNDER SECTOR-17		315.92
1	AREA UNDER 60M BYPASS TRANSFERRED TO NHAI	16.52
2	NET PLANNED AREA	299.40
3	AREA UNDER INDUSTRIAL PLOTS	164.08
4	AREA UNDER WATER WORKS	9.88
5	AREA UNDER CONV. SHOPS	3.04
6	AREA UNDER HSIIDC OFFICE	1.17
7	AREA UNDER POLICE POST	0.29
8	AREA UNDER POST OFFICE	0.26
9	AREA UNDER FIRE STATION	1.50
10	AREA UNDER TEHSIL OFFICE	0.31
11	AREA UNDER BANK	0.24
12	AREA UNDER INSTITUTIONAL PLOTS	1.41
13	AREA UNDER DISPENSARY SITE	1.00
14	AREA UNDER UTILITIES	1.31
15	AREA UNDER PARKING	0.92
16	AREA UNDER WEIGH BRIDGE	0.11
17	AREA UNDER GREEN BELT, ROADS, OPEN SPACES ETC.	113.88

DETAIL OF GENERAL PLOTS

S.NO	SIZE OF PLOTS (IN ACRES)	AREA(in sqm)	No. of plots
1	0.11	450 (15mX30m)	66
2	0.25	1012.5 (22.5mX45m)	71
3	0.25	1012.5 (20.82mX48.63m)	02
4	0.43	1767	02
5	0.44	1800 (30mX60m)	75
6	0.54	2200	01
7	0.76	3113	01
8	0.91,0.99	3700,4000	02
9	1.00	4050	23
10	1.02	4147	01
11	1.05*	4236, 4247.35*	02
12	1.10	4445	01
13	1.15	4654	01
14	1.16	4713	01
15	1.20	4862	01
16	1.30*	5240.79*	01
17	1.31*	5297.63*	01
18	1.35	5470	01
19	1.46	5940	01
20	1.68	6789	01
21	1.79	7275	01
22	2.00,2.05	8094,8300	02
23	2.08	8414	01
24	2.34	9450	01
25	2.51	10160	01
26	2.58	10460	01
27	2.69	10905	01
28	4.89	19800	01
TOTAL			264

AREA* SUBJECT TO DEMARCATION

AREA* SUBJECT TO DEMARCATION

S.NO	SIZE OF PLOTS (IN ACRES)	AREA(in sqm)	No. of plots
SECTOR-17			
1	0.11	450 (15mX30m)	120
2	0.25	1012.5 (22.5mX30m)	97
3	0.44	1800 (30mX60m)	69
4	0.54	4050 (45mX90m)	76
5	2.50	10125 (75mX135m)	06
TOTAL			368

DETAIL OF INSTITUTIONAL PLOTS

S.NO	SIZE OF PLOTS (IN ACRES)	AREA(in sqm)	No. of plots
SECTOR-17			
1	0.48	1942.56	02
2	0.45	1821.15	01
TOTAL			03

DETAIL OF COMMERCIAL PLOTS/ BOOTH'S.(SECTOR-16)

S.NO	SIZE OF PLOTS	AREA(in sqm)	No. of plots
1	6M X 24M	144	40
2	5.5M X 13.75M	75.625	24
3	4M X 12M	48	23
TOTAL			87

NOTE:-
 1. THIS DRAWING SUPERCEDES DRG. NO. HSIIDC/IPD/967, DATED:- 14/04/15.
 2. PLOT NO. 79 & 80 IN SECTOR 16 HAS BEEN OMITTED.
 3. AS PER APPROVAL MD HSIIDC BEARING DRG NO. HSIIDC/IPD/1102, DT. 14.06.2017, A SITE FOR 33/11KV SUB STATION HAS BEEN INCORPORATED.
 4. AS PER APPROVAL MD HSIIDC BEARING DRG NO. HSIIDC/IPD/1369, DT. 25-05-2021, A SITE FOR 33/11KV SUB STATION-B HAS BEEN INCORPORATED.
 5. THIS DRAWING SUPERCEDES PREVIOUS DRG. NO. HSIIDC/IPD/1057, DATED:- 12/11/16.

LEGEND	
	TO BE PLANNED LATER
	RELEASED LAND
	AREA TRANSFERRED TO FOREST DEPARTMENT IN LIEU OF AFFORESTATION OF KMP EXPRESSWAY PROJECT
	RE-PLANNED POCKETS
	EXCHANGE LAND
	LAND UNDER LITIGATION

DRG. NO. HSIIDC/IPD/1441, DATED:- 04.07.2022. VERSION- 13

DRAWN BY:- GAURAV(-SD-)

A.T.P. :- SHIVANI(-SD-) D.T.P. :- SAVITA JINDAL(-SD-)

S.T.P. :- USHA KIRAN(-SD-) C.T.P. :- DINESH SINGH CHAUHAN(-SD-)

DIRECTOR CONTROLLED AREA CUM M.D. HSIIDC:- VIKAS GUPTA(-SD-)